

MGG Lampen-Fassungen / MGG Lamp Holder

MGG 20103-11

1A

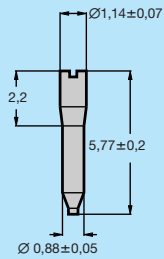

Einzelkontakt für Print-Montage, vergoldet. Für alle Bi-Pin-Lampen.
Single contact for PCB, goldplated.
For all Bi-Pin-Lamps.

MGG 20104-11

1B

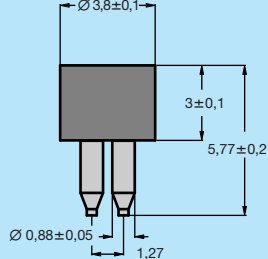

Fassung für Bi-Pin-Lampen im Raster 1,27 mm (Kontakte vergoldet).
Lampholder for Bi-Pin-Lamps modul 1.27 mm (goldplated contacts).
(T-3/4 → T-1)
Material/material → POLYAMID (GV)

MGG 20105-11

1C

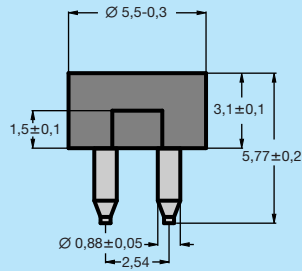

Fassung für Bi-Pin-Lampen im Raster 2,54 mm (Kontakte vergoldet).
Lampholder for Bi-Pin-Lamps modul 2.54 mm (goldplated contacts).
(T-1 → T-1 1/4)
Material/material → POLYAMID (GV)

MGG 20106-17

1D

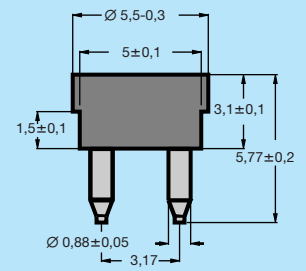

Fassung für Bi-Pin-Lampen im Raster 3,17 mm (Kontakte vergoldet).
Lampholder for Bi-Pin-Lamps modul 3.17 mm (goldplated contacts).
(T-1 → T-1 3/4)
Material/material → POLYAMID (GV)

MGG 20101-11

2A

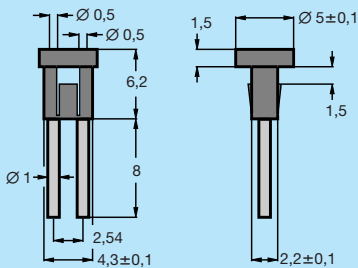

Fassung für Bi-Pin-Lampen im Raster 2,54 mm für Print- oder Einrast-Montage.
Lampholder for Bi-Pin-Lamps, modul 2.54 mm for PCB or Snap-In-Mounting.
(T-1 → T-1 1/4)
Material/material → MACROLON

MGG 20102-17

2B

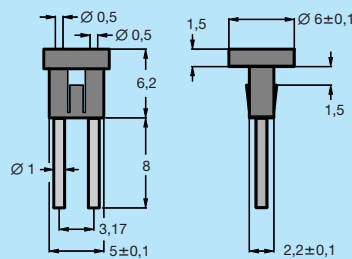

Fassung für Bi-Pin-Lampen im Raster 3,17 mm für print- oder Einrast-Montage
Lampholder for Bi-Pin-Lamps, modul 3.17 mm for PCB or Snap-In-Mounting.
(T-1 → T-1 3/4)
Material/material → MACROLON

MGG 20177-17

2C

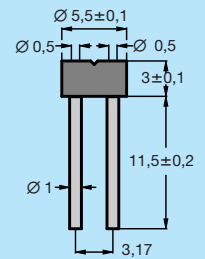

Fassung für Bi-Pin-Lampen im Raster 3,17 mm.
Lampholder for Bi-Pin-Lamps, modul 3.17 mm.
(T-1 → T-1 3/4)
Material/material → MACROLON

MGG 20152-11

3A

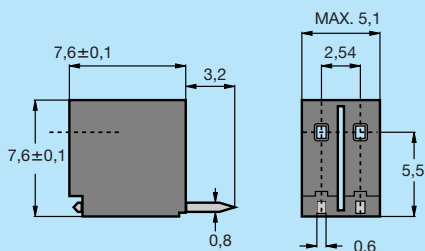

Fassung für Bi-Pin-Lampen im Raster 2,54 mm.
Lampholder for Bi-Pin-Lamps, modul 2.54 mm.
(T-1 → T-1 3/4)
Material/material → NORLYL

MGG 20162-11

3B

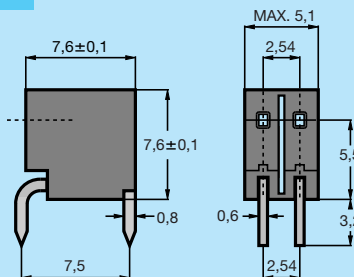

Fassung für Bi-Pin-Lampen im Raster 2,54 mm.
Lampholder for Bi-Pin-Lamps, modul 2.54 mm.
(T-1 → T-1 3/4)
Material/material → NORLYL

MGG 20160-45

3C

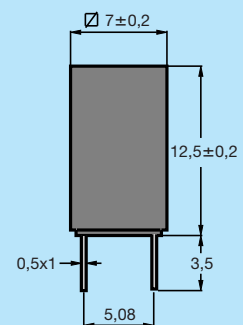

Fassung für Lampen T-1 1/4 mit WEDGE-Sockel W2x4.6d.
Holder for T-1 1/4 Lamps with WEDGE-Base W2x4.6d.
Material/material → MACROLON

MGG 20109-01

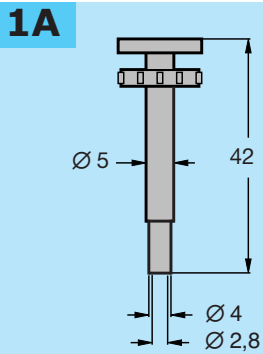

Lampenzieher für T-1 Lampen.
Extractors for T-1 Lamps.

MGG 20183-05

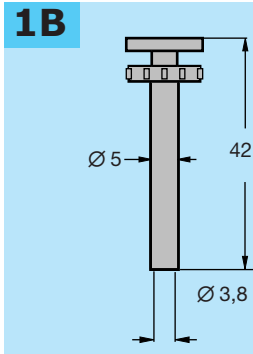

Lampenzieher für T-1 1/4 Lampen.
Extractors for T-1 1/4 Lamps.

MGG 20184-06

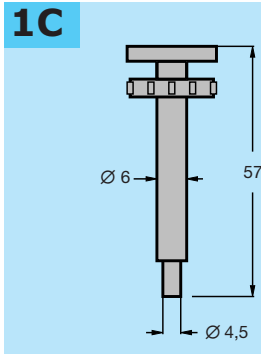

Lampenzieher für T-1 1/2 Lampen.
Extractors for T-1 1/2 Lamps.

MGG 20110-07

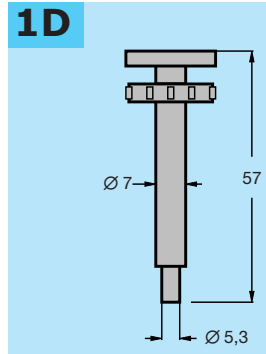

Lampenzieher für T-1 3/4 Lampen.
Extractors for T-1 3/4 Lamps.

MGG 20170-47

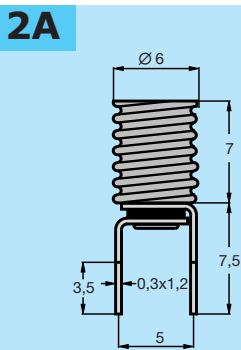

Fassung für Lampen T-1 1/2 und T-1 3/4 mit Sockel E5/8.
Holder for T-1 1/2 and T-1 3/4 Lamps with Midget-Screw-Base E5/8 (L.E.S.)

MGG 20164-48

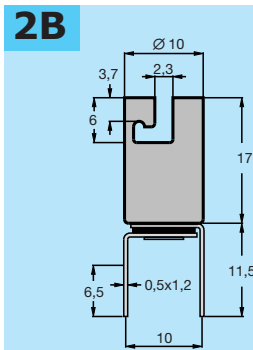

Fassung für Lampen T-3 1/4 mit Sockel BA9s.
Holder for T-3 1/4 Lamps with BA9s-Base.

MGG 20161-48

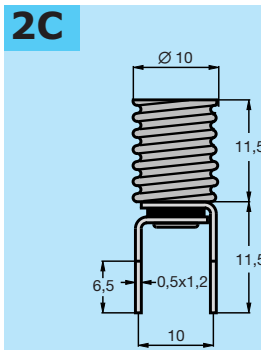

Fassung für Lampen T-3 1/4 mit Sockel E10.
Holder for T-3 1/4 Lamps with E10-Base.

MGG 20134-78

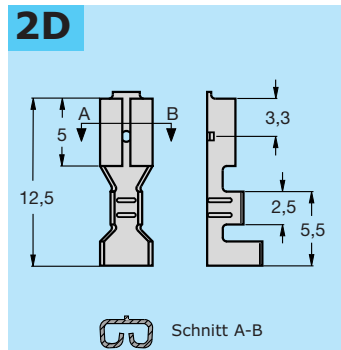

Flachsteckhülse für Steckerbreite 2,8 mm (n. DIN 46330)
Receptacle for tab with 2.8 mm (DIN 46330)

**SILIKON-Farbkappen (Filter) für Miniatur-Lampen
Colored SILICONE-Caps (Filters) für Miniature-Lamps**

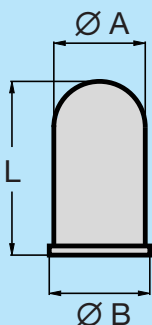

Farbe/Color

	3A	3B	3C	3D	3E
	T-3/4	T-1	T-1 1/4	T-1 3/4	T-3 1/4
	ØA = 2,8 L = 5,1 ØB = 2,8	ØA = 3,5 L = 6,6 ØB = 3,8	ØA = 4,6 L = 10,3 ØB = 4,9	ØA = 5,3 L = 10,3 ØB = 5,5	ØA = 9,9 L = 13,4 ØB = 10,2
rot/red	20492-841	20192-811	20592-851	20792-871	20892-881
grün/green	20493-842	20193-812	20593-852	20793-872	20893-882
gelb/yellow	20494-843	20194-813	20594-853	20794-873	20894-883
blau/blue	20495-844	20195-814	20595-854	20795-874	20895-884
opal-weiß/white	20496-846	20196-816	20596-856	20796-876	20896-886
blau-weiß/blue-white	20497-845	20197-815	20597-855	20797-875	20897-885
orange/orange	20498-847	20198-817	20598-857	20798-877	20898-887
klar-matt/clear-frosted	20403-848	20203-818	20503-858	20703-878	20803-888